

HERADESIGN® superfine

Sound absorption values

- 1 α_w up to 0.85 NRC = up to 0.85



with acoustic lining

- 2 α_w up to 1.00 NRC = up to 1.00

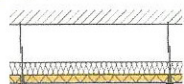

suspended with acoustic lining

Humidity resistance

up to 95% RH

Dimensions

For sizes as well as supply categories please consult www.knaufamf.com

Thickness / Weight

15 mm / 7.8 kg/m²

25 mm / 11.3 kg/m²

35 mm / 15.0 kg/m²

Colours

White, similar to RAL 9010 / beige – natural tone 13
(further shades available from colour systems such as RAL, NCS, BS or StoColor)

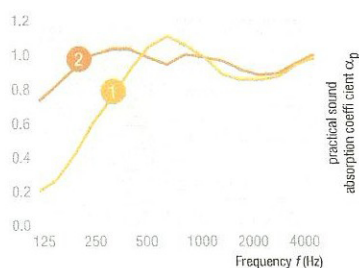

Systems

- 1 Suspended ceiling with concealed T-profiles
- 2 Screw mounting onto wooden laths
- 3 Screw mounting onto CD profiles
- 4 Suspended ceiling with exposed T-profiles



HERADESIGN® fine

Sound absorption values

- 1 α_w up to 0.80 NRC = up to 0.85

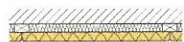

with acoustic lining

- 2 α_w up to 0.90 NRC = up to 1.00

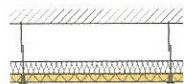

suspended with acoustic lining

Humidity resistance

up to 95% RH

Dimensions

For sizes as well as supply categories please consult www.knaufamf.com

Thickness / Weight

15 mm / 8.2 kg/m²

25 mm / 12.4 kg/m²

35 mm / 16.3 kg/m²

Colours

White, similar to RAL 9010 / beige – natural tone 13
(further shades available from colour systems such as RAL, NCS, BS or StoColor)

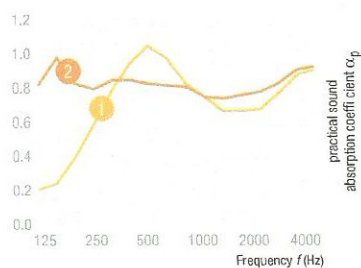

Systems

- 1 Suspended ceiling with concealed T-profiles
- 2 Screw mounting onto wooden laths
- 3 Screw mounting onto CD profiles
- 4 Suspended ceiling with exposed T-profiles



HERADESIGN® macro

Sound absorption values

- 1 α_w up to 0.70 NRC = up to 0.75



with acoustic lining

- 2 α_w up to 0.70 NRC = up to 0.75

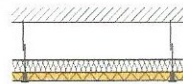

suspended with acoustic lining

Humidity resistance

up to 95% RH

Dimensions

For sizes as well as supply categories please consult www.knaufamf.com

Thickness / Weight

25 mm / 12.4 kg/m²

Colours

White, similar to RAL 9010 / beige – natural tone 13
(further shades available from colour systems such as RAL, NCS, BS or StoColor)

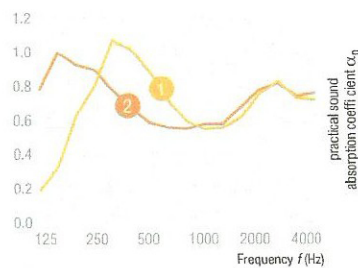

Systems

- 1 Suspended ceiling with concealed T-profiles
- 2 Screw mounting onto wooden laths
- 3 Screw mounting onto CD profiles
- 4 Suspended ceiling with exposed T-profiles

